

TOP FIX INLINE PLATE

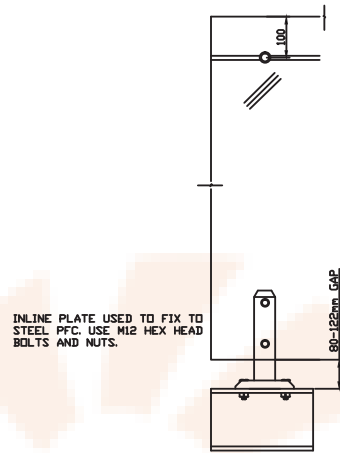

INLINE PLATE USED TO FIX TO STEEL PFC. USE M12 HEX HEAD BOLTS AND NUTS.

CORE DRILL FIXING

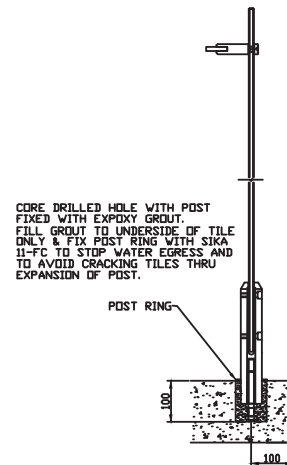

CORE DRILLED HOLE WITH POST FIXED WITH EPOXY GROUT. FILL GROUT TO UNDERSIDE OF TILE ONLY & FIX POST RING WITH SIKKA 11-FC TO STOP WATER EGRESS AND TO AVOID CRACKING TILES THRU EXPANSION OF POST.

TOP FIX 90 DEGREE PLATE

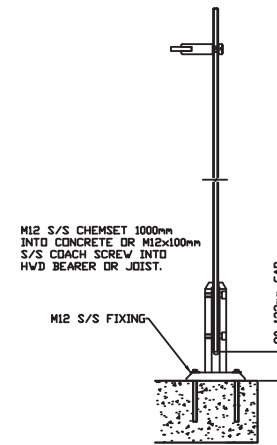

M12 S/S CHEWSET 1000mm INTO CONCRETE OR M12x100mm S/S COACH SCREW INTO HWD BEARER OR JOIST.

M12 S/S FIXING

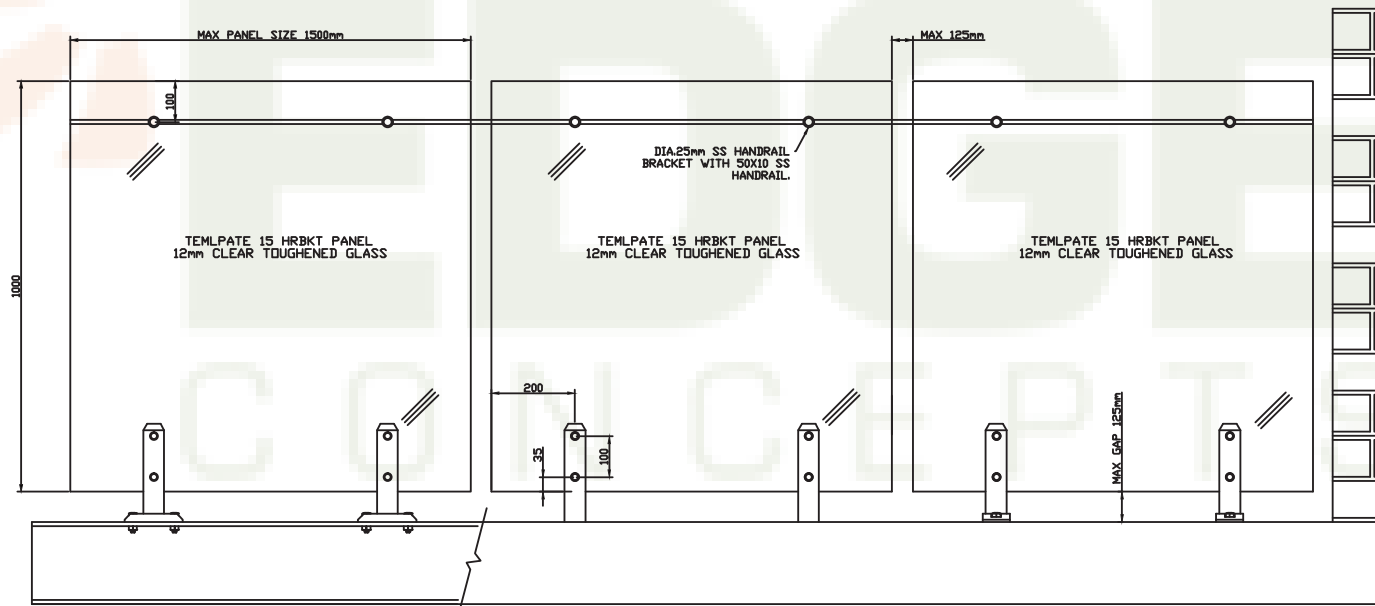

NOTES: SUITABLE FOR EDGE PROTECTION GREATER THAN 1000mm.
IF PANELS ARE TO BE USED AS AN INTERLINKING HANDRAIL THEN THERE MUST BE A MINIMUM OF 3 PANELS 1000mm WIDE.
FOR LANDING HEIGHTS 0-5m TOUGHENED GLASS IS ACCEPTABLE, FOR LANDING HEIGHTS ABOVE 5m HEAT SOAKED TOUGHENED GLASS IS REQUIRED.

EDGE CONCEPTS (QLD) PTY LTD 50-52 KABI CIRCUIT DECEPTION BAY 4508 PH.3897 8700 FAX.3897 8777	PART NO. D12 MINI POST GLASS BALUSTRADE	
	DESCRIPTION. ANODISED ALUMINIUM MINI POST	
	SCALE: NTS	DATE: JAN 2012